

1 2 3 4 5 6

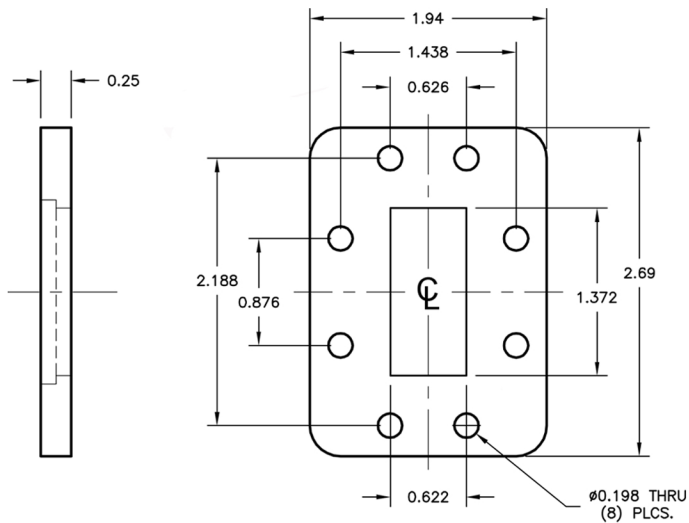

WR137 CPRF FLANGE

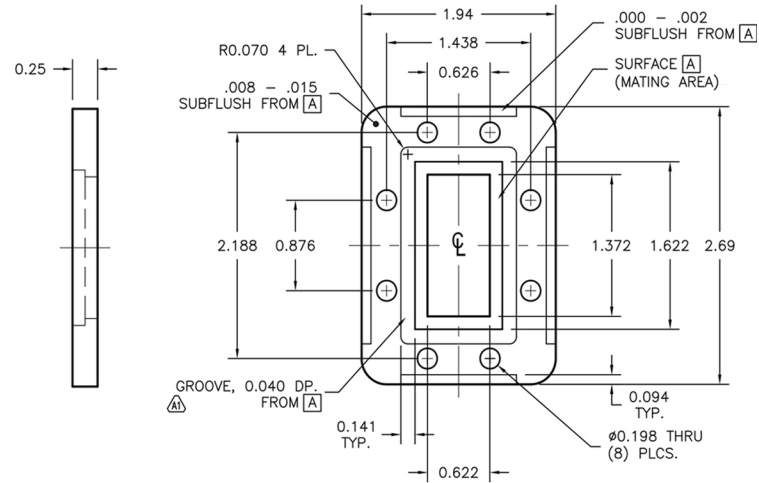

WR137 CPRG FLANGE

SPECS

WAVEGUIDE SIZE: WR137
 FREQUENCY: 5.85 - 8.2 GHZ
 VSWR: 1.25:1
 CONNECTOR: TYPE N, F OR M
 MATERIAL: 6061 ALUMINUM
 FINISH: BLUE ANODIZE

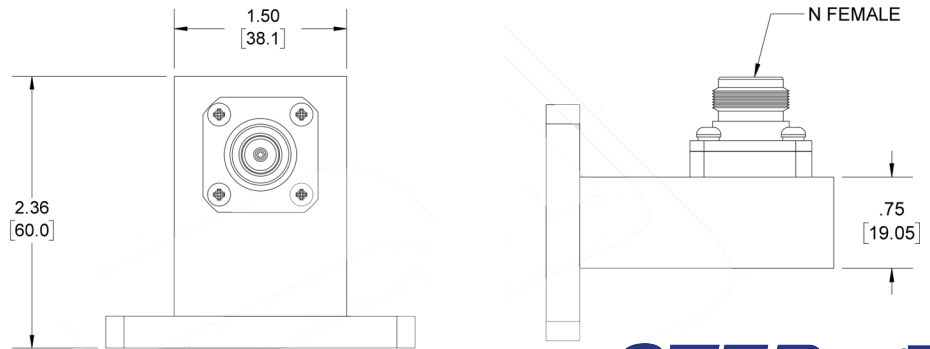

Type	Order Code
WR137 WG to coax adapter (F)	AST1002-5R-F (FEMALE CONNECTOR,CPRF FLANGE)
WR137 WG to coax adapter (M)	AST1002-5G-M (MALE CONNECTOR,CPRG FLANGE)

FLANGE CODES: CPRF=R, CPRG=G



BREAK ALL CORNERS AND SHARP EDGES

REVISIONS		APPROVALS			
SYM	DESCRIPTION	DATE	ENGR	PROD	Q.A.

PROPRIETARY INFORMATION
 THIS DOCUMENT CONTAINS PROPRIETARY INFORMATION WHICH SHALL NOT BE REPRODUCED, TRANSFERRED TO OTHER DOCUMENTS, DISCLOSED TO OTHERS, USED FOR MANUFACTURING OR ANY OTHER PURPOSE WITHOUT PRIOR WRITTEN PERMISSION FROM AST.

UNLESS OTHERWISE SPECIFIED	DRAWN	
FRACTIONAL ± 1/32	CHECKER	
DECIMAL .XXX ± .010	MECH. ENGR.	
ANGULAR .XX ± .020	ELEC. ENGR.	
± 1/2°	PROJ. ENGR.	
MATERIAL: NOTED	CHIEF ENGR.	
SPEC:		
FINISH: NOTED		
SPEC:		

WR137 WAVEGUIDE TO COAXIAL ADAPTER (N)		SCALE	NTS	SHEET 1 OF 1
DRAWING # AST1002-5				